

PF 200 Flush Exit Device



Door Closed



Door Open

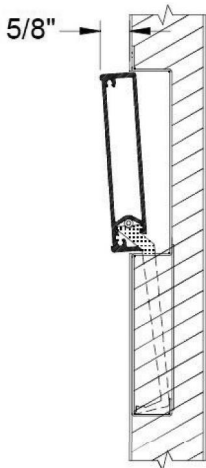
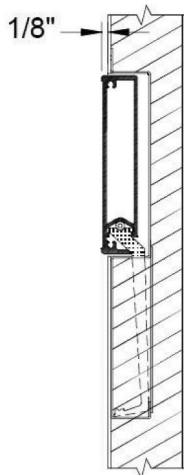

SPECIFICATIONS

Lengths	<ul style="list-style-type: none"> • 24" For width of 2'5" and wider • 14" For width of 1'7" to 2'-4-15/16"
Height	<ul style="list-style-type: none"> • 4-3/8"
Projection	<ul style="list-style-type: none"> • 5/8" Closed 1/8" Open
Centerline from bottom of door	<ul style="list-style-type: none"> • 39-9/16" Standard Height • 34-9/16" Elementary Height
Finishes	<ul style="list-style-type: none"> • 628 Satin Anodized Aluminum • 710 Dark Bronze Anodized • 711 Black Anodized • Insert to match door body • Architectural metal inserts: 629, 630, 707, 667, 710

Exit Devices

- ADA compliant
- Fire rated up to 3 hours
- Limited lifetime warranty
- Available with levers, operating grips or exit only
- Only Electrical Unlatching and Fail Secure functions available
- Factory installed as an integral part of the Total Door system
- Cycle tested to over 5 million cycles versus 500 thousand required by BHMA and ANSI standards for exit devices